

1 2 3 4 5 6 7 8

REVISIONS				
ZONE	REV	DESCRIPTION	DATE	APPROVED

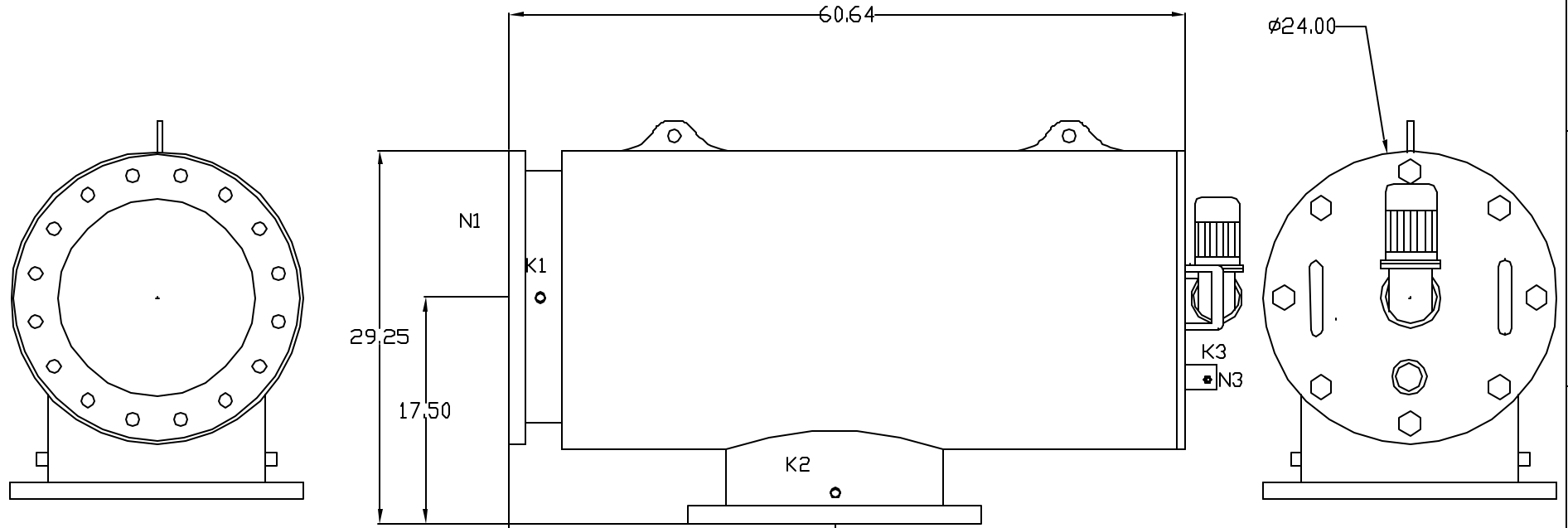

TECHNICAL DATA

Flow Rate	Max. 6000 GPM
Screen Size	----- Micron
Screen Area	16.5 sq.ft (Perf.)
Working Temp.	200 deg. F
Working Pressure	150 PSI
Empty Weight	--- lbs.
Full Weight	----- lbs.

NOZZLE	CONNECTION	TYPE OF CONNECTION	SIZE	RATING
K1	Hi. Press. Conn.	Threaded	1/4" NPT(2)	
K2	Low Press. Conn.	Threaded	1/4" NPT(2)	
K3	Hydraulic Conn.	Threaded	1/4" NPT(2)	
N1	Inlet	Flanged	16" ASA	150 lbs. F.F.
N2	Outlet	Flanged	16" ASA	150 lbs. F.F.
N3	Flushoutlet	Threaded	2" NPT	

<small>UNLESS OTHERWISE SPECIFIED DIMENSIONS ARE IN INCHES TOLERANCES</small> <small>DECIMALS ANGULAR</small> <small>XX ± .05 ± 0.5 DEG</small> <small>XXX ± .01</small>		AUTOMATIC FILTERS, INC. 2672 S. LA CIENEGA BLVD. LOS ANGELES, CA 90034 (310) 839-2828 FAX (310) 839-6878	
DRAWN Daniel Stenberg		DATE 4-10-06	
CHECKED		TITLE CSB 16-L Coarse Screen Brush Filter	
DESIGN		SIZE A	DWG NO. CSB16-L
		REV 0	SHEET OF
		NOT SCALE	

E
D
C
B
A